

*Explore the
Serengeti*

AT ROVING BUSHTOPS



BUSHTOPS
SAFARI CAMPS



LOCATION

Having pioneered the idea of 'wild luxury' at Mara Bushtops and Serengeti Bushtops, we were determined that our third Bushtops location should be at least their equal for game viewing and comfort alike.

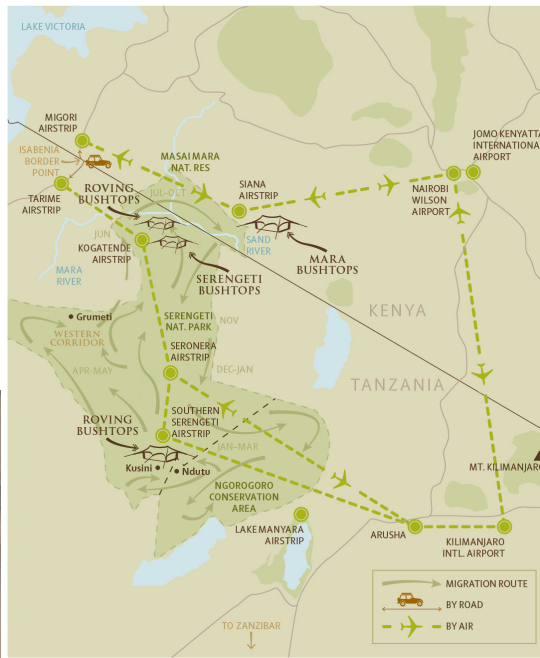

However, we wanted something different - unique even - so in 2015 we came up with the concept of Roving Bushtops, a luxury safari camp on wheels which could move between bases to make the most of the annual migration.

During the winter we pitch camp at Kusini in the southern Serengeti to witness the birth of the next generation of migrating wildebeest and zebra. We then spend June to October in the northern Serengeti near the Mara river, watching the migrating herds as they head into the Masai Mara and back again, crossing rivers as they go.

<i>Roving Bushtops schedule at a glance</i>	
<i>Northern Serengeti</i>	<i>Southern Serengeti/Kusini</i>
1 June to 30 Oct 2024 / 2025	21 Dec 2024/25 31 March 2025/26

The wildebeest and their attendant zebras follow their own mysterious migratory timetable, so precisely where and when they can be found is impossible to predict with total confidence. Having two locations gives us the best chance of being in the right place at the right times.

However, with or without the migration, the most spectacular show on earth never ends. For anyone who loves nature and wide-open vistas, both Roving Bushtops locations provide fabulous year-round access to the Serengeti's animals, birds and flora at their most thrilling. The sheer quantity of game here is phenomenal at any time, with resident herbivores stalked by loping leopards, charismatic cheetah and languid lions.

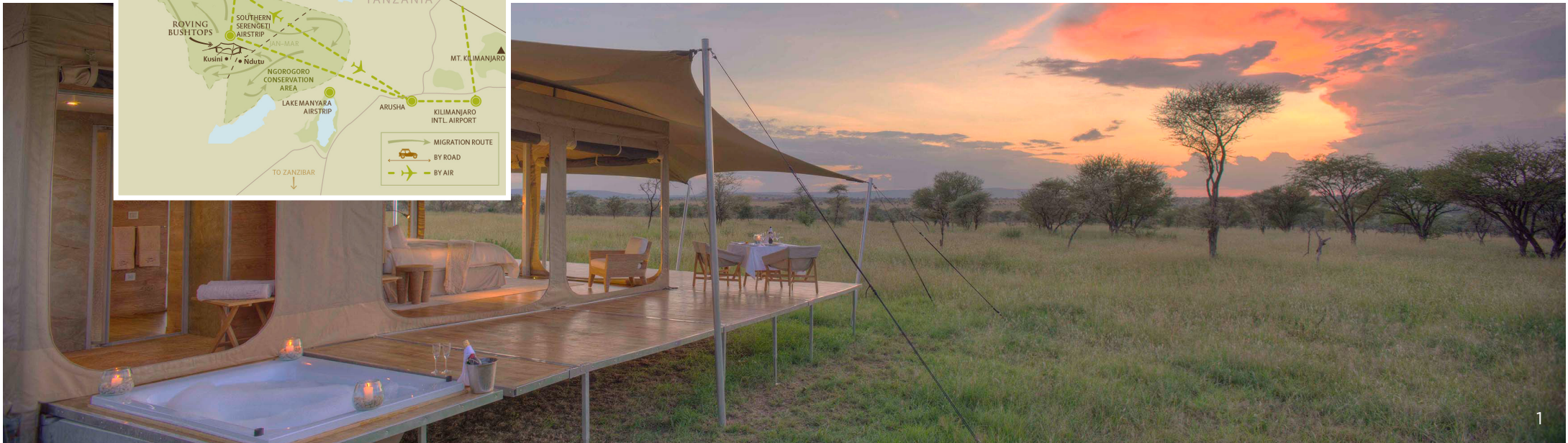



VENUE

.....

Guests stay in eight superbly-specified tents, featuring king-size beds and 24 hour power. Each en-suite bathroom includes a flushing toilet, bath, vanity basins and open sided showers.

We make sure there is absolutely no compromise on indulgence, with every need being catered for through 24 hour butler service.

During the day, tent walls can be opened on three sides, enabling panoramic views of the surrounding bush.

EXPERIENCE

.....

However tempting it may be to luxuriate in camp, the true glory of Roving Bushtops is its immediate access to the world's greatest wildlife spectacles. There is no need to travel to the animals: they are all around you. We drive amongst them, not to reach them.

Daily game drives are led by expert rangers, supported by keen-eyed local spotters. We have always sourced and converted some of the best gameviewing vehicles in East Africa, so each day's roving takes place in superbly equipped, ultra-reliable open 4x4 Land Cruisers.

As each day draws to a close, you and your fellow guests can re-gather at Roving Bushtops' dining tent. Here you select from a sophisticated menu in a haven of contemporary luxury, set against arguably the world's greatest safari backdrop. Alternatively you can wine and dine in the privacy of your own tent.

And when you leave, we know that unforgettable memories will combine with the knowledge that you have left no environmental footprint whatsoever, helping to preserve one of the most special places on earth.



ROVING BUSHTOPS CAMP

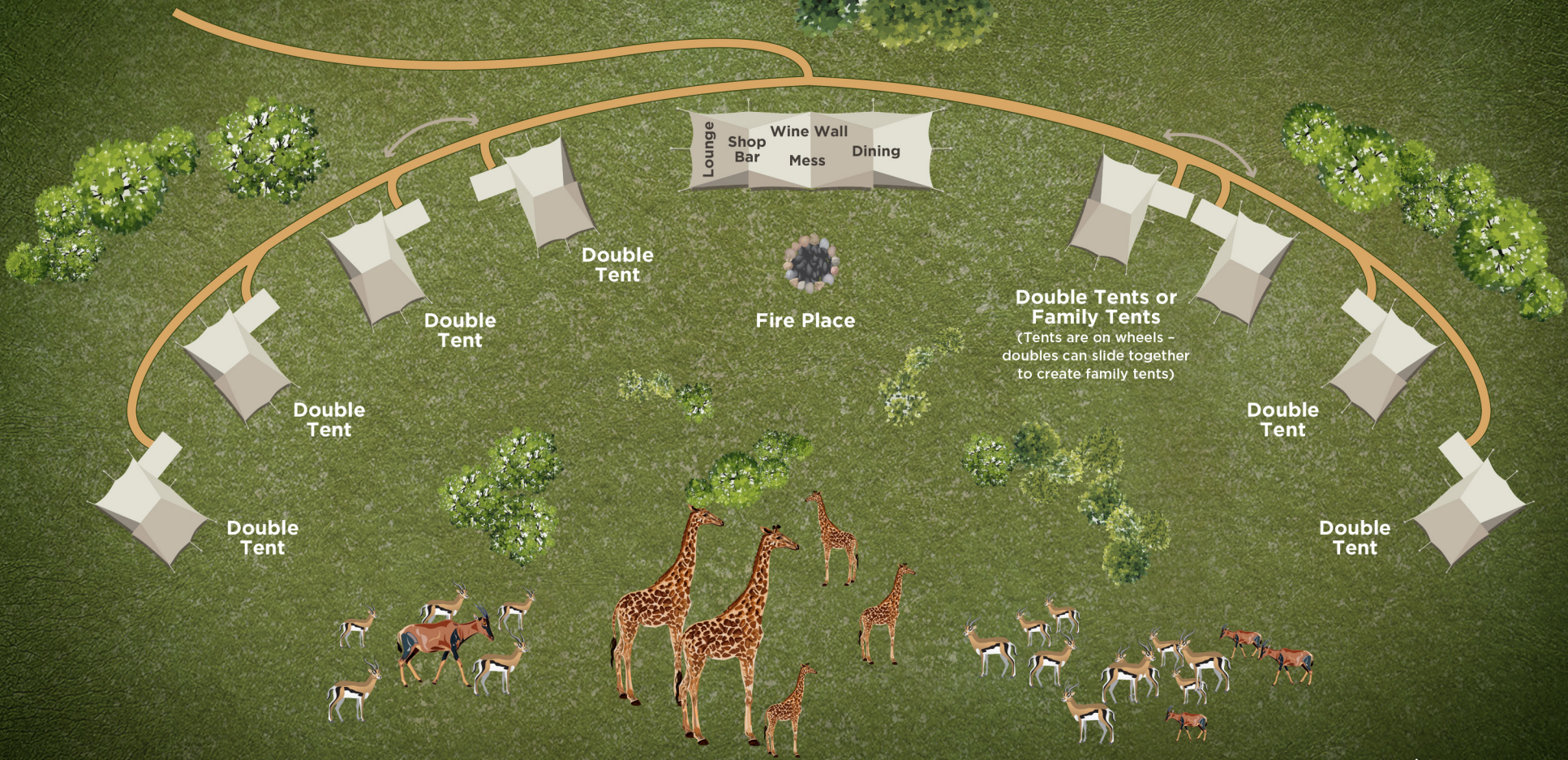



TENTS

8 tents (twin and double on request) max of 1 extra bed (child or adult) can be added to each tent.

The tents are on wheels and can be moved next to each other.

CHILDREN

Children are welcome from the age of 7 and we grant children's rates up to the age of 17.

TENT FACILITIES

The tents open up on 3 sides. The bathroom has a bathtub and shower. The tent walls can be opened up to get the feeling of being outside.

The tents are beautifully furnished in a contemporary style and have loungers and dining table on the wooden deck which spans over 100 square metres .

All tents are equipped with a safe, hair dryer, 220v AC.

CAMP FACILITIES

24 hr power and complimentary wifi (due to the remote location of the camp, the wireless connection can be slow and intermittent).

24 hr butler service and private dining in the tent on request.

Mini shop with specially selected local crafts and souvenirs.

Mini library.

Complimentary laundry service.

Cellphone reception available (the signal may be intermittent and limited to WhatsApp calls in Kusini).

Check in is at 2pm and checkout 10am, but we do everything possible to remain flexible.

CAMP FACILITIES

All dining is included and on an à la carte basis.

Dining is in the elegant mess tent, in the privacy of your tent or under the stars.

All non alcoholic drinks, beers, premium wines and all spirits included (French champagne not included).

Please let us know your dietary requirements in advance. We can adapt to most requests.

BEST TIME TO VISIT

December to March at Kusini to get the best possible vantage point for the migration and witness the birthing season (around February).

June to October in the central Serengeti which is rich in wildlife all year round. Due to the central location, game drives can be conducted in various areas including the Central Serengeti as well as towards the eastern and western corridor.

June and October in the central Serengeti for the migration in the immediate area or within a game drive's reach.

Temperatures range from min. approx 8°C/42°F to max. approx 30°C /86°F.

Rainfall predominantly occurs in November, April and May.

Closed in April and May and parts of November and December.

GUEST SAFETY

Roving Busstops is not fenced off and guests are requested to be vigilant at all times. Guests must be accompanied by our security staff when moving from their tent to the main building in the early mornings, evenings and night. Children must be supervised by parents at all times.

ACTIVITIES

Game drives are on a private basis.

Bush picnics, sun downers.

Complimentary massages.

Balloon safari package includes: transfers, pre flight briefing, 1-1½ hrs balloon flight and champagne style bush breakfast.

Bushcraft Challenge for Children.

Guided nature walk around Camp grounds.

PAYMENT TYPES ACCEPTED

Credit cards: Visa, MasterCard, Amex

Currency: US Dollar bills printed after 2000

LOCATION

Central Serengeti

Airstrip: Seronera

Altitude: 1580m

GPS coordinates of camp:

Lat S 2° 28'46.16"

Lon E 34° 43'10.09"

Southern Serengeti

Airstrip: Southern Serengeti

Altitude: 1536m

GPS coordinates of camp:

Lat S 2°56'10.0"

Lon E 34°40'28.7"

LUXURY TENT

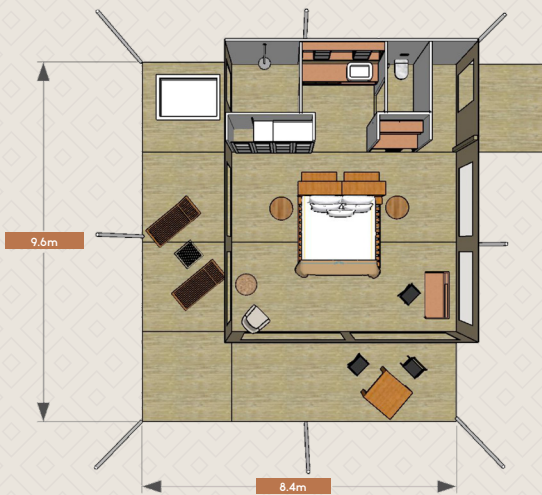

Family tent



BUSHTOPS

SAFARI CAMPS

